

G-411

Wire Rope Thimbles

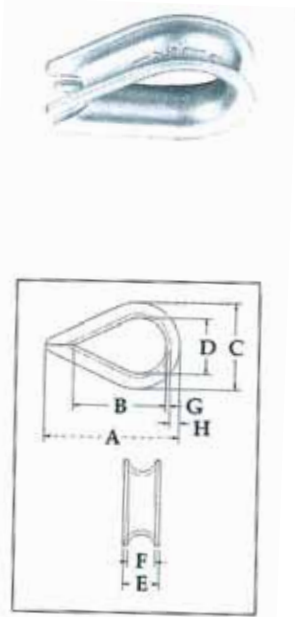

- Hot Dip galvanized steel.
- The standard choice for light duty applications and loading conditions.
- Meets the performance requirement of EN13411-11:2002.

Standard Wire Rope Thimbles

Rope Dia. (mm)	Weight per 100 (Kg)	Dimensions (mm)							
		A	B	C	D	E	F	G	H
3-4	1.59	49.3	33.3	26.9	17.5	6.35	4.05	1.25	3.30
5	1.59	49.3	33.3	26.9	17.5	7.85	5.60	1.25	3.30
6-7	1.59	49.3	33.3	26.9	17.5	9.65	7.10	1.25	3.30
8	1.81	54.0	38.1	31.8	20.6	11.2	8.65	1.25	3.30
9-10	3.04	60.5	41.4	37.3	23.9	13.5	10.4	1.50	4.06
11-13	5.67	70.0	47.8	44.5	28.7	17.5	13.5	2.05	4.83
16	15.7	89.0	57.0	60.5	35.1	23.1	16.8	3.30	8.64
18-20	21.4	95.5	63.5	68.5	41.4	27.4	19.8	3.55	8.64
22	38.4	127	89.0	81.0	47.8	32.3	23.9	4.05	11.2
24-26	44.2	145	108	95.5	63.5	35.3	26.9	4.05	10.4
28-32	79	159	114	109	70.0	44.5	33.3	5.60	12.7

G-414

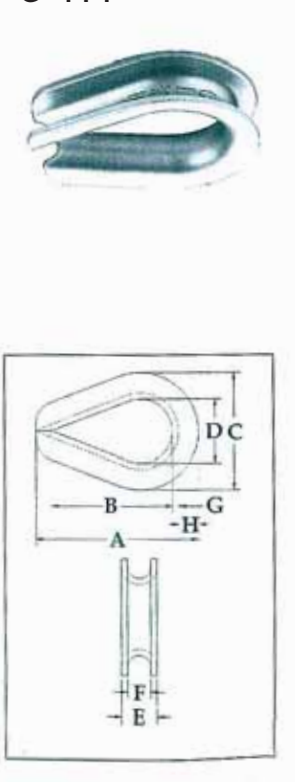

- Available in Hot Dip galvanized or Stainless Steel (Type 304).
- Meets the performance requirements of EN13411-1:2002.
- Stainless steel recommended for more corrosive environments where greater protection is required.
- Greater protection against wear and deformation of the wire rope eye.
- Longer service life.

Extra Heavy Wire Rope Thimbles

Rope Dia. (mm)	G-414 Stainless (Stock No.)	Weight per 100 (Kg)	Dimensions (mm)							
			A	B	C	D	E	F	G	H
* 6-7	1037960	2.95	55.5	41.1	38.1	22.4	11.2	7.10	1.50	5.85
* 8	1037988	5.35	63.5	47.8	46.0	26.9	14.0	8.65	2.05	7.10
* 9-10	1038004	9.80	73.5	54.0	54.0	28.7	16.8	10.4	2.80	8.65
11-12	-	15.7	82.5	60.5	60.5	31.8	18.8	11.9	3.30	9.65
* 13-15	1038022	23.1	92.0	70.0	70.0	38.1	23.4	13.5	3.55	10.4
* 16	1038040	34.3	108	82.5	79.5	44.5	26.2	16.8	4.05	12.7
* 18-20	1038068	72	127	95.5	96.5	51.0	33.0	19.8	5.60	16.8
22	-	81	140	108	108	57.0	37.3	23.9	5.60	19.1
24-26	-	142	156	114	125	63.5	44.5	26.9	6.35	22.4
28-32	-	181	178	130	149	73.0	47.8	33.3	6.35	28.7
32-35	-	402	230	165	173	89.0	57.2	36.6	9.65	28.7
35-38	-	587	229	159	181	89.0	66.5	39.6	12.7	28.7
40	-	771	286	203	207	102	76.2	43.7	12.7	35.1
44	-	805	310	229	216	114	77.7	46.7	12.7	33.3
48-52	-	1259	384	305	264	152	85.9	53.0	12.7	38.1
56	-	1792	435	356	302	178	98.6	60.5	16.0	41.4

Wire Rope Thimbles

G-408 (OPEN PATTERN)



- Hot Dip galvanized steel.
- Meets the performance requirement of EN13411-11:2002.
- Recommended for light duty applications in which it is being assembled into another fitting (i.e., shackle or master link).

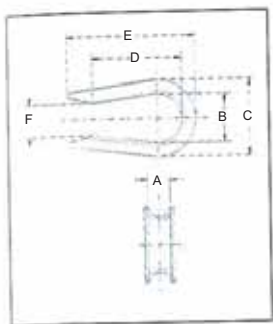

Open Pattern Thimbles

Rope Dia. (mm)	Weight per 100 (Kg)	Dimensions (mm)					
		A	B	C	D	E	F
6-7	1.36	7.10	17.5	26.9	35.9	51.5	9.65
8	1.72	8.65	20.6	31.8	38.9	55.0	12.7
9-10	3.18	11.2	23.9	37.3	43.7	62.5	15.7
11-13	5.67	13.5	28.4	44.5	37.3	72.0	19.1
16	11.3	16.8	35.1	60.5	59.5	91.0	25.4

S-412



- Cast Ductile Iron
- Fits pin for open wire rope socket, boom pendant clevis and wedge socket.

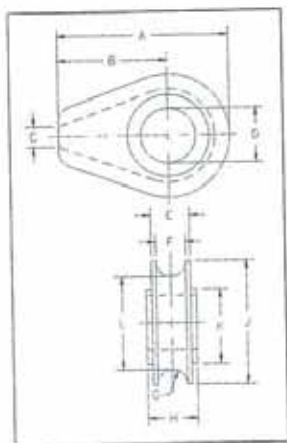

Solid Wire Rope Thimbles

Rope Dia. (mm)	Weight Each (Kg)	Dimensions (mm)										
		A	B	C	D	E	F	G	H	J	K	L
13	.28	71.5	44.5	6.35	26.9	19.1	14.2	7.10	22.4	54.0	41.4	39.6
16	1.00	119	76.0	9.65	33.3	26.9	20.6	10.4	28.7	86.0	57.0	65.0
18-20	1.05	119	76.0	9.65	38.1	26.9	20.6	10.4	35.1	86.0	57.0	65.0
22	2.47	154	97.0	12.7	44.5	35.1	26.9	13.5	41.4	114	82.5	87.5
24-26	2.38	154	97.0	12.7	54.0	35.1	26.9	13.5	46.0	114	82.5	87.5
28-30	4.21	184	116	16.0	60.5	44.5	33.3	16.8	52.5	137	98.5	103
32-35	4.45	154	116	16.0	67.0	49.3	38.9	19.8	58.5	137	98.5	105