

Closed Spelter Sockets

Closed grooved Sockets meet the performance requirements of Federal Specification RR-S-550D, Type B, except for those provisions required of the contractor.

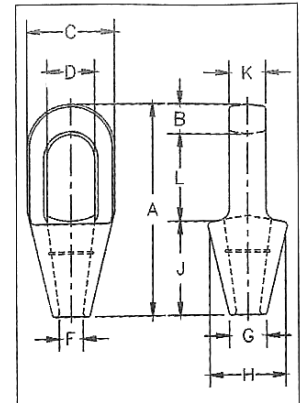

- Forged Steel Sockets Thru 38mm, cast alloy steel 40mm thru 100mm.
- Spelter socket terminations have an efficiency rating of 100%, based on the catalog strength of wire rope. Ratings are based on the recommended use with 6x7, 6x19, or 6x37, IPS or XIP (EIP), XXIP (EEIP), RRL, FC, or IWRC wire rope.

NOTICE:

All cast steel sockets 40mm and larger are magnetic particle inspected and ultrasonic inspected. Proof testing available on special order. Drawing illustrates one groove used on sockets 6mm thru 19mm. Sizes 22mm thru 38mm use 2 grooves. Sizes 40mm and larger use 3 grooves.

G-417/S-417
Closed Spelter Sockets

Rope Dia (mm) †	Structural Diameter (in.)	Weight Each (kg)	Dimensions (mm)									
			A	B	C	D	F	G	H	J	K	L
6-7	-	.23	116	12.7	39.6	22.4	9.65	17.5	39.6	57.2	12.7	46.0
8-10	-	.34	125	15.8	42.9	24.6	12.7	20.6	42.9	57.2	17.5	52.3
11-13	-	.68	140	17.5	51.0	29.5	14.2	23.9	51.0	63.5	22.4	58.7
14-16	12-13	1.13	162	20.6	67.0	35.8	17.5	30.2	67.0	76.2	25.4	65.0
18	14-16	1.92	194	26.9	76.2	42.2	22.4	33.3	70.0	89.0	31.8	77.7
20-22	18-19	3.28	226	33.3	92.0	49.3	25.4	38.1	82.5	102	38.1	90.5
24-26	20-22	4.76	254	36.6	105	58.5	28.7	44.5	95.5	114	44.5	103
28-30	24-26	6.46	283	39.6	114	65.0	31.8	51.0	105	127	51.0	116
32-35	28	8.95	309	41.4	127	71.0	38.1	58.5	119	138	56.5	129
38	30-32	13.24	355	49.3	137	81.0	41.4	70.5	132	151	62.5	155
† 40-42	33-35	16.32	390	54.0	146	82.5	44.5	76.2	140	165	70.0	171
† 44-48	36-40	25.96	445	55.5	171	95.5	51.0	79.5	162	191	76.2	198
† 50-54	42-45	35.83	505	62.0	194	111	57.2	95.5	187	216	82.5	224
† 56-60	46-48	47.62	546	70.0	216	127	66.8	105	210	229	92.0	248
† 64-67	50-54	63.50	597	79.5	241	140	74.5	114	235	248	102	270
† 70-73	56-62	99.79	645	79.5	273	159	79.5	124	259	279	124	286
† 75-80	64-67	125	689	85.6	292	171	86.0	133	292	305	133	298
† 82-86	70-73	142	743	102	311	184	92.0	146	311	330	146	311
† 88-92	76-80	181	787	102	330	197	98.5	160	330	356	159	330
† 94-102	-	246	845	108	362	216	108	184	362	381	178	356

* Diameter of pin must not exceed pin used on companion 416 socket.
Reference adjacent page "D" dimension.

† Cast Alloy Steel