



## Chain Slings and Accessories

Offering Safety Material

### Bolt Dee Shackles

- U.S. Federal Specification RR-C-271D.
- Forged, quenched and tempered with alloy pin.
- Fatigue tested.
- Embossed with OSM Logo, Traceability Code & WLL.
- Proof Load at 2 times WLL.
- Ultimate Strength at 6 times WLL.



Type: **SBD**

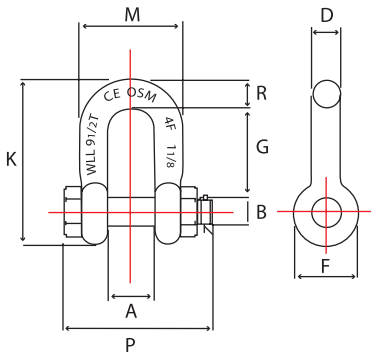

#### Forged Bolt Dee Shackle Type: SBD

Product Code	Nominal Size (in.)	WLL 6:1 Ton	Kg	Dimension(mm)									Tolerance(+/-)	
				A	B	D	F	G	K	M	P	R	C	A
SBD 013	1/2	2	0.3	20.6	16.0	12.7	30.2	41.4	77.0	46.0	71.0	12.70	3.30	1.50
SBD 016	5/8	3.1/4	0.7	26.9	19.1	16.0	38.1	51.0	95.5	58.5	89.5	16.00	3.30	1.50
SBD 019	3/4	4.3/4	1.1	31.8	22.4	19.1	46.0	60.5	115.0	70.0	103.0	20.60	6.35	1.50
SBD 022	7/8	6.1/2	1.8	36.6	25.4	22.4	53.0	71.5	135.0	81.0	120.0	24.60	6.35	1.50
SBD 025	1	8.1/2	2.5	42.9	28.7	25.4	60.5	81.0	151.0	93.5	135.0	25.40	6.35	1.50
SBD 028	1.1/8	9.1/2	3.5	46.0	31.8	28.7	68.5	91.0	172.0	103.0	150.0	31.80	6.35	1.50
SBD 032	1.1/4	12	4.9	51.5	35.1	31.8	76.0	100.0	191.0	115.0	165.0	35.10	6.35	1.50
SBD 035	1.3/8	13.1/3	6.2	57.0	38.1	35.1	84.0	111.0	210.0	127.0	183.0	38.10	6.35	3.30
SBD 038	1.1/2	17	8.4	60.5	41.4	38.1	92.0	122.0	230.0	137.0	196.0	41.10	6.35	3.30
SBD 044	1.3/4	25	14.2	73.0	51.0	44.5	106.0	146.0	279.0	162.0	230.0	54.00	6.35	3.30
SBD 050	2	35	21.2	82.5	57.0	51.0	122.0	172.0	312.0	238.0	344.0	51.00	6.35	3.30
SBD 063	2.1/2	55.0	38.6	104.8	68.0	63.5	152.4	203.2	418.8	270.0	419.0	63.50	6.35	3.30

www.marinehub.com